

BRADLEY ESTATES & RIDGE | SPRING VALLEY TRAILS |  
TRAILSEDGE | EASTBORO

# Annual General Meeting

May 14<sup>th</sup> 2019

Orleans, Ontario

Rendez-vous des aînés francophones d'Ottawa

# Agenda

- Welcome
- President's annual report: community updates
- Directors' annual reports: Schools, Parks, Rinks
- Treasurer's report
- Councillor's welcome
- Upcoming events
- Nomination/election of officials
- Q&A
- Adjournment

2018-19 BECA volunteers and BoD  
(representative of all neighbourhoods in BECA)

Yasmine Fathers (*2019 President*)

Julie Godward

J-P Gravelle (*2019 Treasurer*)

John Heffernan (*2019 Secretary*)

Ginette Godward

Angela Chatterton (*2019 Vice President*)

Yves Brunet

Chris Mosher

**Other volunteers:**

Lorne Wilmott

Dominique Wilmott

Misha Patterson

## BECA objective

**Objectives:** To make our community a safer, cleaner, and fun place to live and play  
To ensure that our community has optimal access to services and facilities.

- Incorporated, not-for-profit community organization made up of **volunteers** from the neighbourhood.
- Represent the **interests** of the homeowners of the **Bradley Estates, Bradley Ridge, Spring Valley Trails, Trailsedge/Enclave, Eastboro** neighbourhoods (board is representative of areas)

Follow Us



BECA Orleans

BECA Orleans Business and  
Classifieds

[www.bradleyestates.ca](http://www.bradleyestates.ca)

Blog, Reporting form

## What do we do?

- Liaise with the **Councillor's office** via regular emails/calls/meetings
- Work with **City departments, OPS, other organizations**
- **Research and review plans** affecting our community and provide input to city departments
- **Gather information and share** with community
- Attend meetings at City Hall and other consultations for **matters that impact our neighbourhood**
- **Apply for grants** for improvements in our parks and other areas
- Throw **parties** and organize **community events**

# Community Updates

- **Projects (park and ride, Brian Coburn Extension)**
- **Traffic calming**
- **Schools update**
- **Parks update**
- **Rinks update**

# Projects



# Chapel Hill Park and Ride

- Construction is proceeding on schedule, should be completed by **November 2019**
- Actual opening date is being confirmed with OC Transpo senior management
- Plan (next slide) depicts parking lot area, transit component and main vehicular access from Navan Road into site.
- Main entrance on Navan Road equipped with traffic signals
- Site access on Brian Coburn Blvd is primarily for bus access, with allowance for public vehicles from westbound Brian Coburn Blvd
- Transit platform will be equipped with 2 passenger shelters, 1 bicycle shelter and benches.

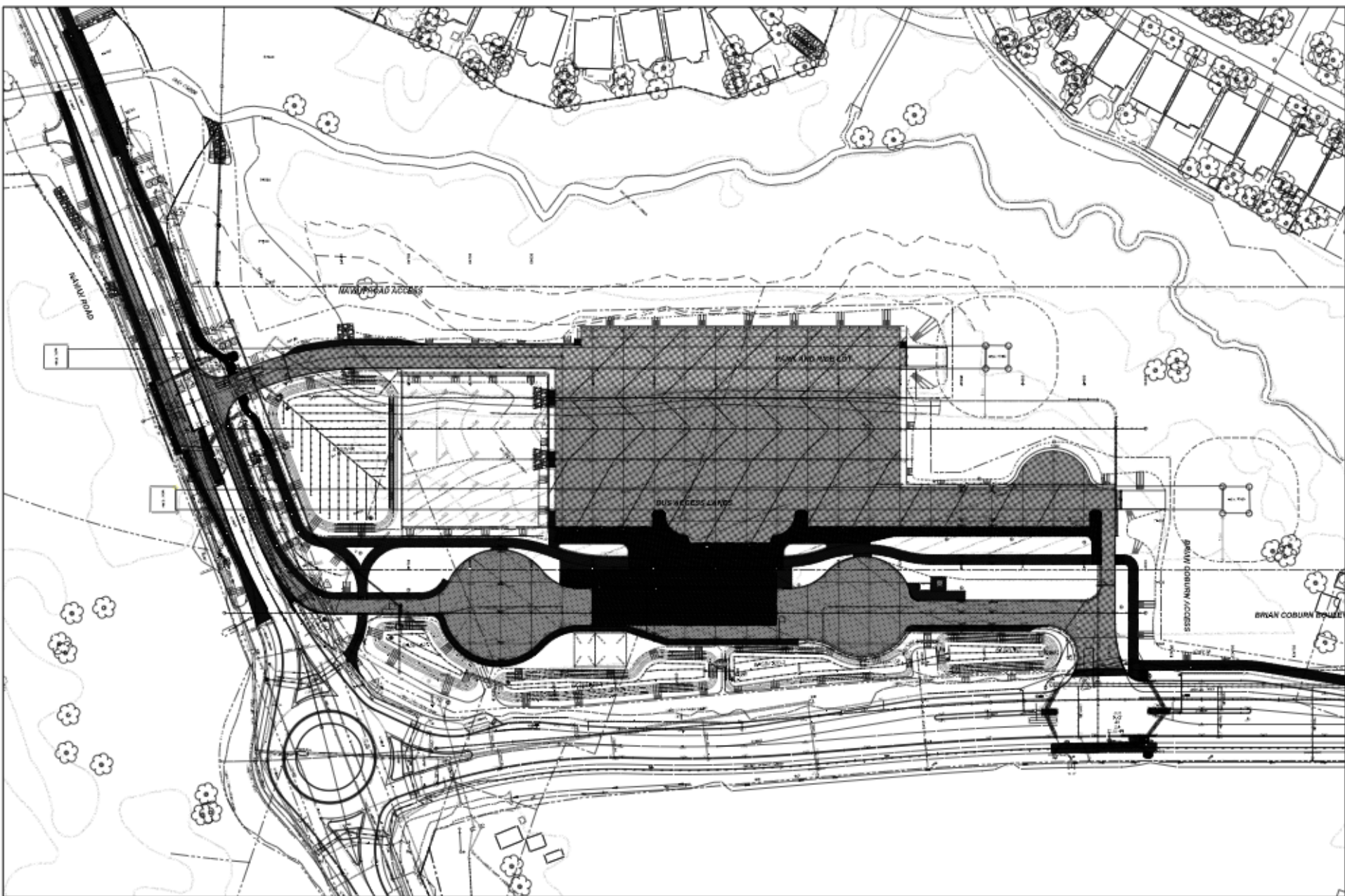

# Brian Coburn Extension alternate EA

- Next set of consultation group meetings in June along with a Public Open House; timing is yet to be confirmed.
- Bradley Estates pathway connection to the Park and Ride will be identified as part of the on-going EA
- No plans have yet been made to identify timing of this connection as the design has yet to be established.

# Traffic Calming

# Renaud East:

- ✓ Pedestrian Crossing - Renaud Rd at NDC
- Permanent Slow Down for Us (2018)
- ✓ Speed Radar board
- ✓ School zone speed limit
- Crossing guard (since 2016)

## Renaud East (school zone):

- ✓ 4 speed humps approved from Penency to Compass (5th future speed hump past Compass) (2015/2018)

## Renaud East (school zone):

- ✓ 3 speed humps approved from Penency to Compass
  - Concentrated around PXO
- Crossing guard?
- ✓ Thermoplastic school zone signs in asphalt

# Locations of Flat Top Speed Humps





## Renaud West:

- Area Traffic Management Study 2017-18
- Recommended speed humps w/ gaps
- Survey rejected
- Revision of recommendation ongoing
  - Medians, gateway sign

# Saddleridge/Spring Valley/Joshua:

- Aggressive measures will direct MORE traffic to cut-through area
- Speed boards, flex signs
- Precedent-setting for other streets like Axis, Compass

Schools update

# OCDSB

- Currently students are sent to Glen Ogilvie and Emily Carr (Blackburn). These schools are not at capacity.
- Last year OCDSB completed its District Needs Analysis during which they observed the growth and projected growth in the EUC growth area (East Urban Community- south of Innes, west of Mer Bleue Road, south and west of NCC greenbelt) and determined 3 new schools would be needed.
- Currently 230 JK- 8 OCDSB students residing in the area, expected to increase to 522 by 2025.
- 2 sites currently “development-ready”: Joshua Street & Spring Valley Drive, Axis Way & Fern Casey Street. “...there is no constraint in meeting the timing of the required school with an opening date of 2022.” (Currently #6 on the Capital Priorities List)
- New school is projected to have enrolment of 328 upon opening in 2022, increasing to 522 in five years. Prediction that market share would increase with an OCDSB school in the area.
- Assumed it will be a JK- 8 with Core French and French Immersion.

## **OCDSB Capital Priorities-setting Consultation Process 2018**

**New!** After the completion of a public consultative process which commenced in January of this year, on May 22nd the OCDSB approved a list of 2018 Capital Priorities as follows:

Capital Priority #1 – a new Fernbank Elementary School – planned opening 2020

Capital Priority #2 – a new Riverside South Secondary School – planned opening 2020

Capital Priority #3 – a second new Half Moon Bay Elementary School – planned opening 2020

Capital Priority #4 – a permanent addition to Viscount Alexander Public School

Capital Priority #5 – a permanent addition to A.Y. Jackson Secondary School

Capital Priority #6 – a new East Urban Centre Elementary School – planned opening 2022

Capital Priority #7 – a second new Findlay Creek Elementary School – planned opening 2022

Capital Priority #8 – a second new Riverside South Elementary School – planned opening 2023

The provision of capital funding for construction of the above priorities is determined by the Ministry of Education. These decisions typically take place as part of a call for capital submissions from school boards across the province. The timing of the next Ministry capital call is not yet known.

**Note that the above projects have been identified as capital priorities by the OCDSB but have not yet received funding from the province for their completion.** Those with planned opening dates which meet the timing criteria contained in the next Ministry capital call will be submitted for consideration.

# OCSB

-Waiting for information from the Province before proceeding with any future capital planning studies.

-The Ottawa Catholic School Board has several future school sites designated within the Cumberland and Gloucester portions of the East Urban Community (EUC) including:

- a JK-6 elementary site in the Gloucester Portion of the EUC 2;
- we have purchased the 7-12 high school site in the Mer Bleue area on Brian Coburn Boulevard;
- we have designated an additional future elementary site in the Mer Bleue Urban Expansion Area. (South of Renaud near White?)

-Note that a new school in the general area does not automatically ensure that our community will be within the future attendance boundary.

# CECCE

- Dans le cas du Collège catholique Mer Bleue, les conseillères et conseillers du CECCE ont déjà approuvé un projet d'agrandissement de 281 places-élèves, soit l'équivalent de 13 salles de classe. Veuillez toutefois noter que nous sommes en attente d'une directive du ministère de l'Éducation pour soumettre ce projet prioritaire et obtenir un financement.
- En ce qui a trait à l'école élémentaire catholique Notre-Dame-des-Champs, le Conseil a réservé un terrain pour la construction d'une nouvelle école à moyen terme.
- Pour la prochaine année scolaire, il est prévu d'ajouter une classe mobile à Notre-Dame-des-Champs.
- À titre d'information, la nouvelle école élémentaire catholique Notre-Place, qui a ouvert les portes en 2016, a aussi servi à soulager Notre-Dame-des-Champs. L'administration analyse annuellement les besoins en espace de ses écoles et examine les diverses options (classe mobile, agrandissement, nouvelle école, etc.) selon l'orientation et le financement de la Province.



Access to school bus:

M-J : 0 km      1-6 : 1,5 km    7-8 : 2,5 km    9-12 : 3 km

Exceptions for safety reasons:

- Must cross a high traffic volume public road where the speed limit is over 50 km/h
- Must cross a 4 lane public artery
- Must use an artery where there are no sidewalks and where the speed limit is over 50 km/h with high traffic volume
- The limit is over 60 km/h and there are no traffic lights

# CEPEO

-Présentement les élèves de la communauté de Bradley Estates/Mer Bleue fréquentent l'école élémentaire publique Le Prélude et ont le choix de fréquenter les écoles secondaires publiques lorsqu'ils ont accès à OC Transpo, alors que les élèves du secteur rural sont transportés en autobus jaune à l'école secondaire publique Louis-Riel.

-Agrandissement Le Prélude de 12 classes (présentement en construction).

-Le CEPEO a également un terrain de 6 acres réservé au sud du chemin Renaud à l'ouest du chemin Mer Bleue, dans la communauté de Bradley Estates/Mer Bleue pour une future école élémentaire maternelle à la 6e année.

# Parks Update

# Claridge Spring Valley Trails Community Park

- Concept presented to public
- Comment period ended 24 Sept 2018
- Park construction drawings are being reviewed by the City and provided the developer achieves subdivision registration the park is scheduled to begin construction this summer.



# Trailsedge East Park

- Concept presented to public
- Comment period ended 30 April 2019



# Winter Rinks

- Rink masters for Patrick Dugas/Bradley Ridge
- Volunteer & hours for high school students
- Trailers and supervisors
- Corporate sponsors
- Chris and Yves, Directors of Rinks

# Winter Rinks

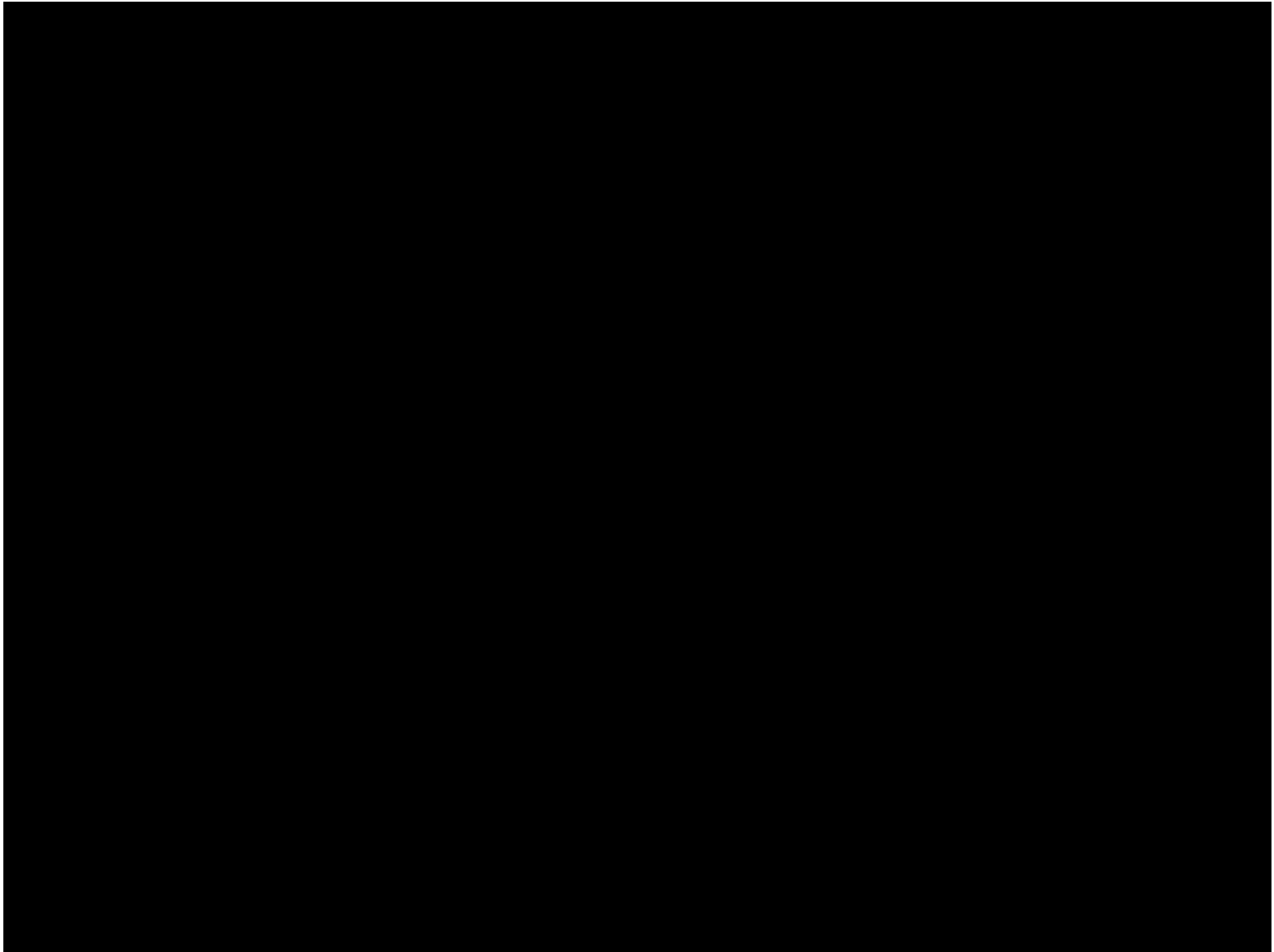



# Patrick Dugas

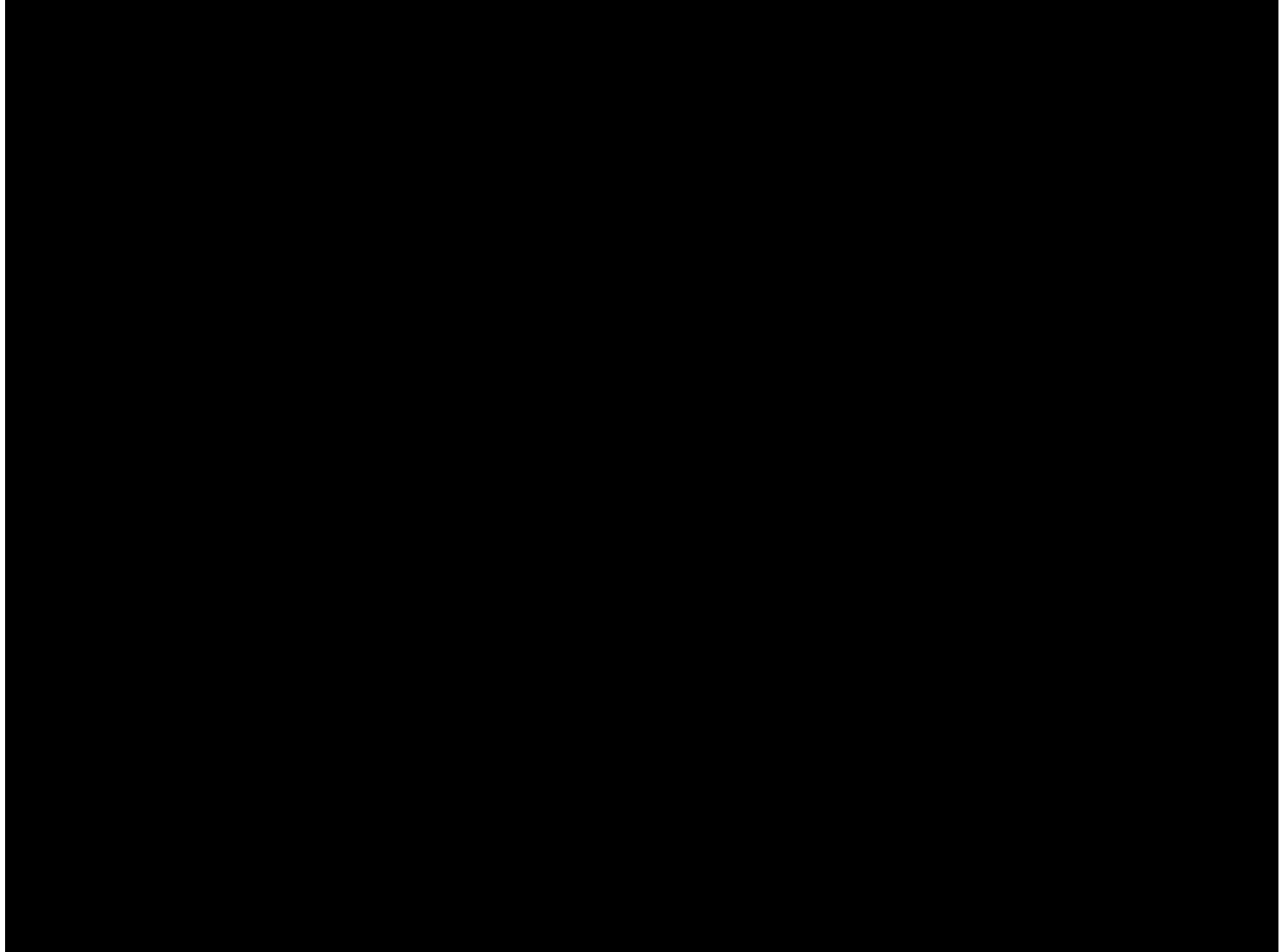

# Bradley Ridge



# Heated Trailers

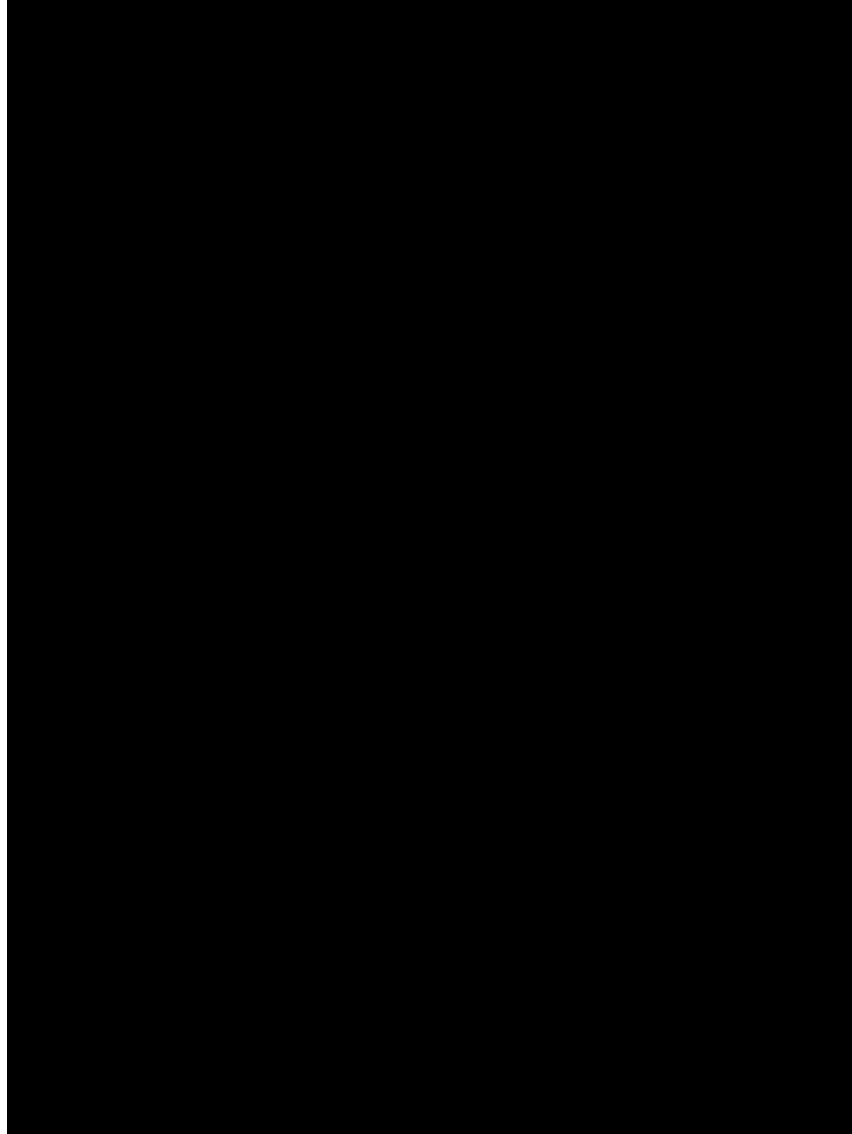

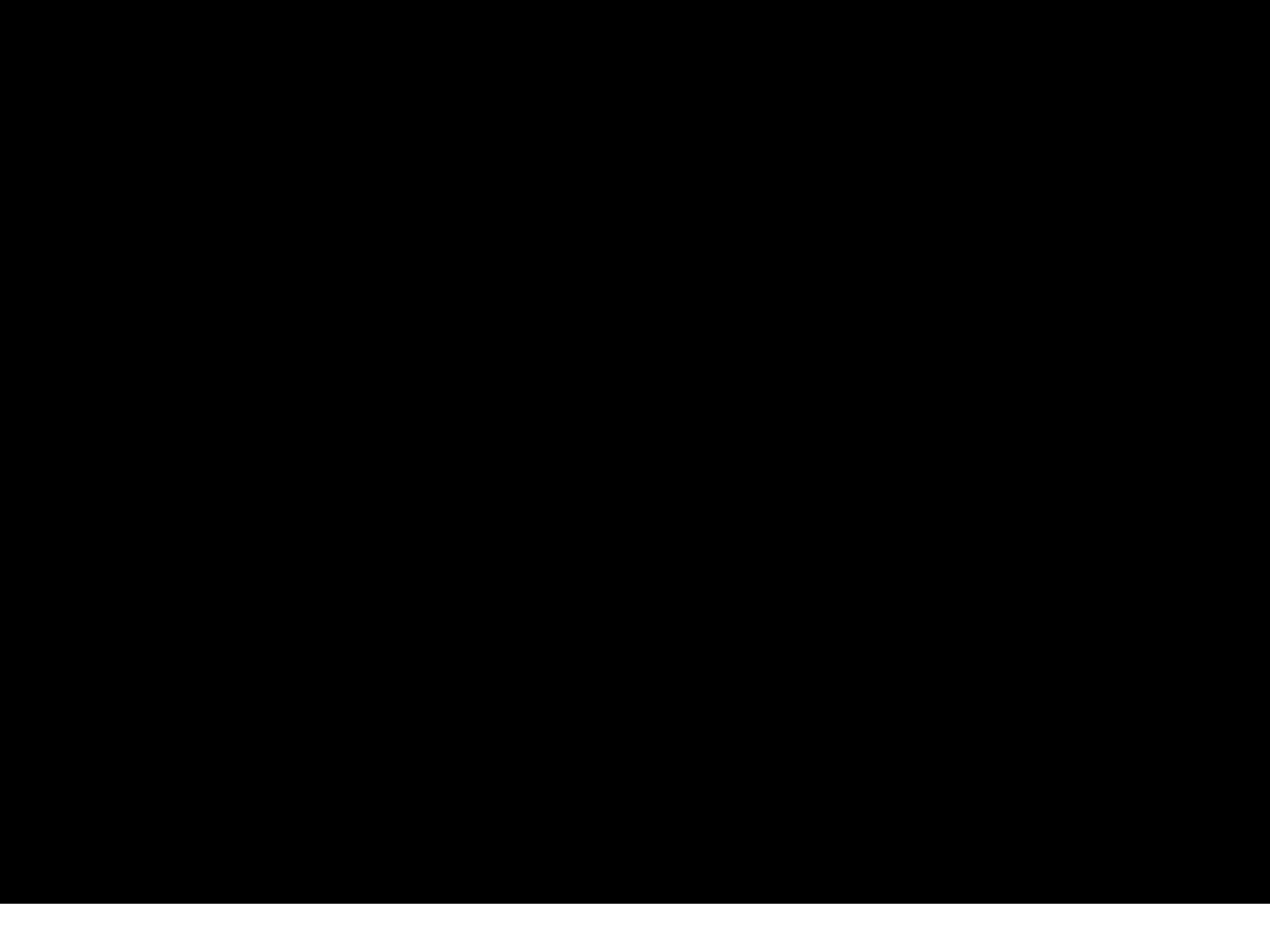

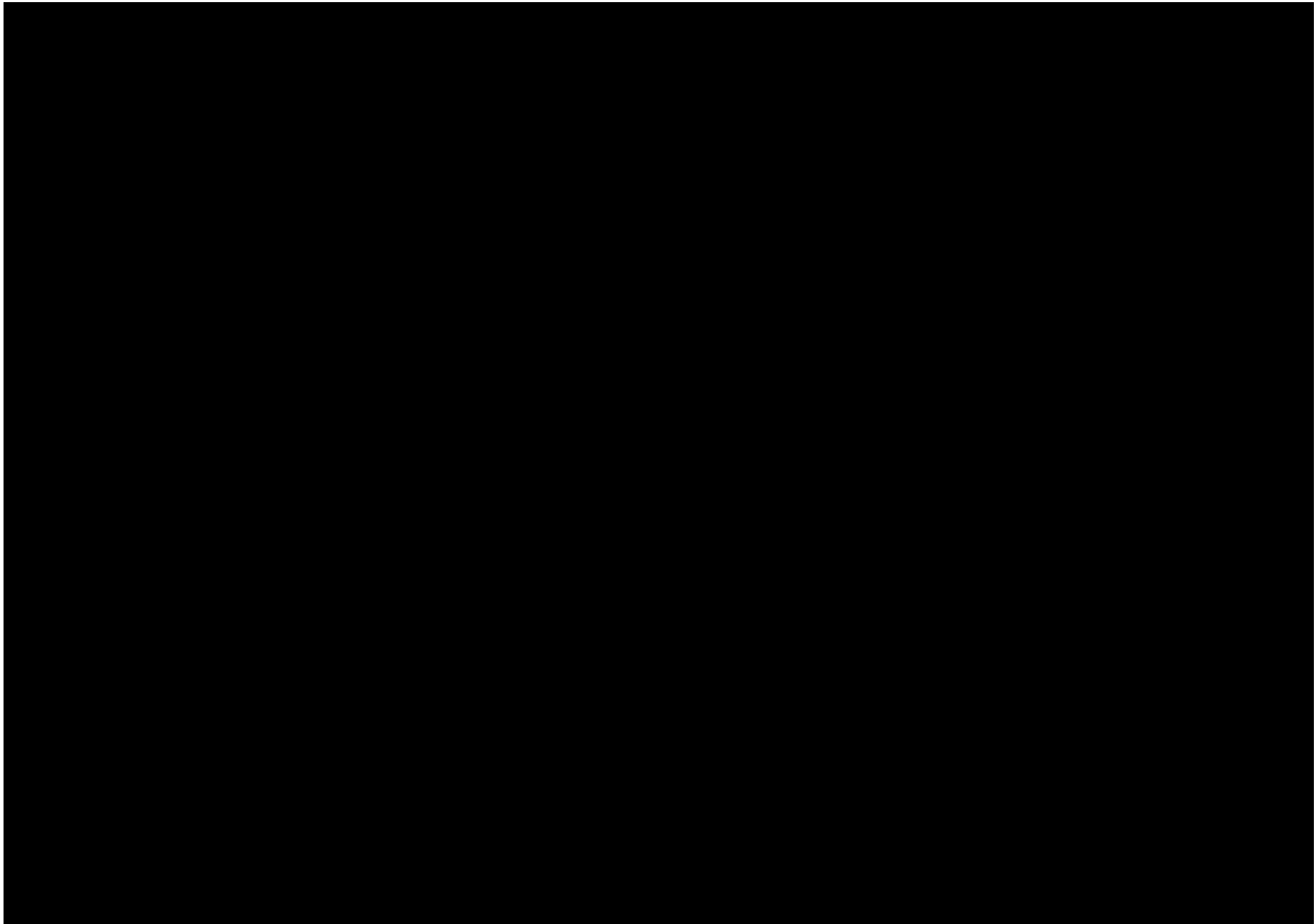



**Councillor Laura Dudas**

# Upcoming BECA Events

- Summer BECA Family Fun Day BBQ Aug 17 at Patrick Dugas
- Movie nights under the stars (tbd)



# 2018 Events



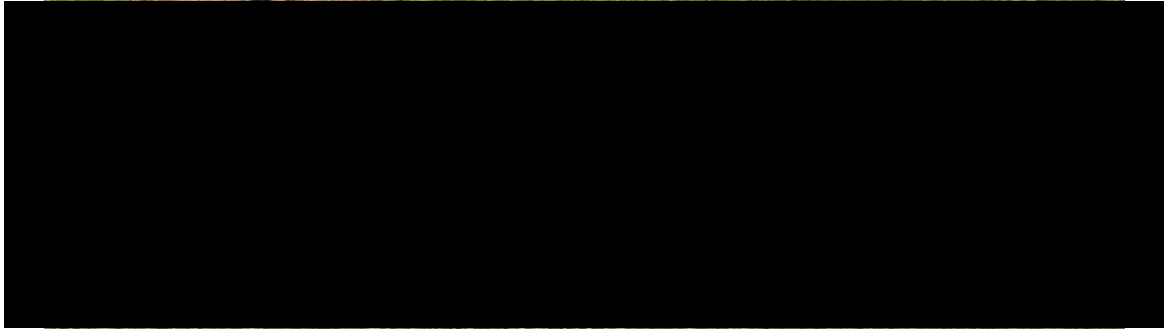

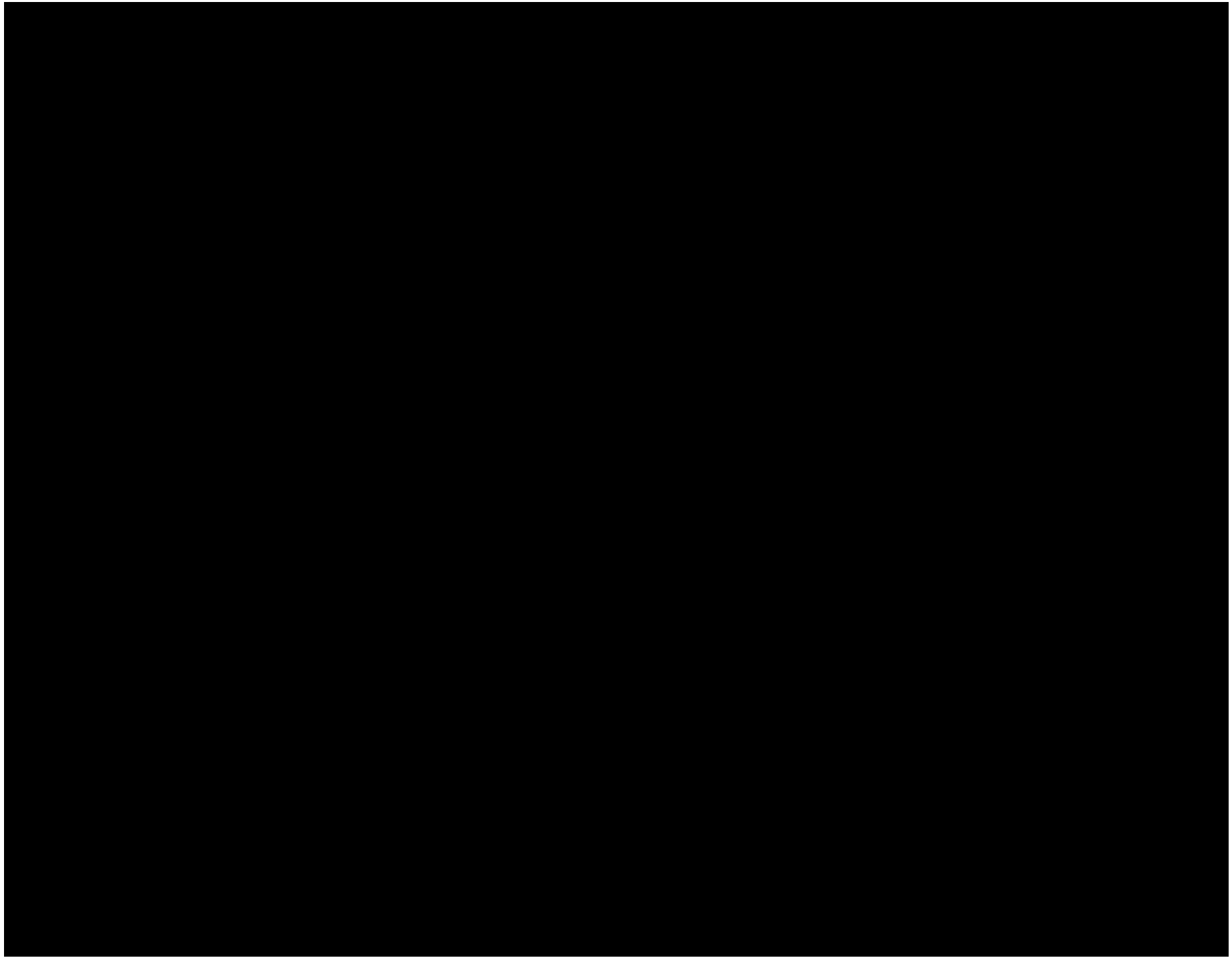

# Grants

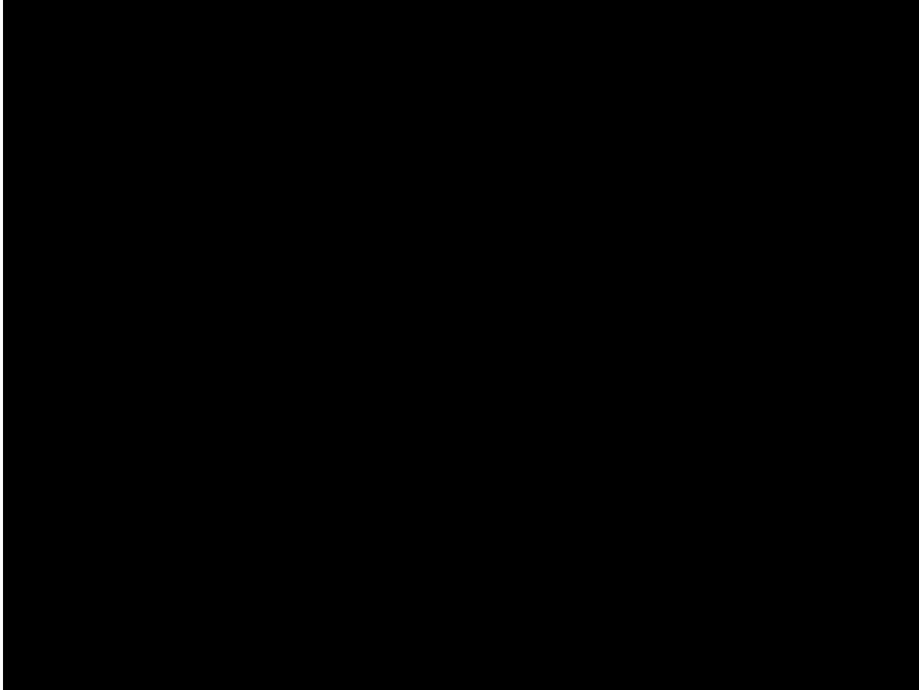

# Fiscal Year 1 May 2018 - 30 April 2019

Statement of Operations and Changes in Net Assets			
For the year ended April 30, 2019			
		2019	2018
<b>Revenues</b>			
Grant - Friends of Mer Bleue - Bradley Ridge & Patrick Dugas Parks Bulletin Boards		0.00	3,500.00
Municipal Grant - Bradley Ridge & Patrick Dugas Parks Bulletin Boards		0.00	1,836.25
Municipal Grant - Bradley Ridge & Patrick Dugas Parks Outdoor Rinks		5,326.00	2,483.06
Friends of Mer Bleue - Community Association Operational Grant		3,000.00	3,000.00
City of Ottawa Recreation Policy 2 yr. acc. balance credit refund		11.40	0.00
Gift - Minto Communities - Patrick Dugas Park Outdoor Rink		0.00	4,620.00
Event Sponsorships		1,150.00	2,300.00
Rink Trailers Fundraising Activity - Donations and Raffle		6,406.00	0.00
Gross Revenues from Organisational Activities		0.00	425.25
<b>Total</b>		<b>15,893.40</b>	<b>18,164.56</b>

<b>Expenditures</b>			
	Commercial General Liability Insurance Policy	319.68	319.68
	Bank and Postal Charges	63.25	42.55
	Advertising and Printing	1,617.79	514.15
	Domain Cost (bradleyestates.ca) - Three years (Paid in FY 2017/2018)	0.00	175.73
	Government of Canada (Annual Return for Corporation)	20.00	20.00
	Donation (Operation Come Home)	0.00	500.00
	Recognition Plaques - Waste Connections & Valecraft Homes	0.00	56.48
	Gross Expenditures for Bradley Ridge Park Bulletin Board	0.00	3,672.50
	Gross Expenditures - Family Fun Day	3,609.58	3,192.39
	Gross Expenditures - Movie Under the Stars	0.00	941.54
	Gross Expenditures for Organisational Activities	496.15	91.52
	Gross Expenditures for Bradley Ridge Park Outdoor Rink	3,759.03	1,480.11
	Gross Expenditures for Patrick Dugas Park Outdoor Rink	2,502.26	2,284.38
	Rink Trailers Rental for Outdoor Rinks	3,715.00	0.00
	<b>Total</b>	<b>16,102.74</b>	<b>13,291.03</b>
<b>(Deficiency) excess of revenue over expenditures</b>		<b>-209.34</b>	<b>4,873.53</b>
<b>Balance, beginning of year</b>		<b>9,070.63</b>	<b>4,197.10</b>
<b>Balance, end of year</b>		<b>8,861.29</b>	<b>9,070.63</b>

# Cell Towers

Telus/Bell: 3354 Navan Road, (in service)

Rogers (1): WCC site (in service)

Rogers (2): Mer Bleue at 6615 Renaud (replacement of existing site)

Rogers (3): 2920 Navan Rd. (in service)

# Wish List



# Community Centre?

- Closest community buildings are NDC Community Hall (considered part of our community although not central) and Aquaview Community Hall.
- District park (8ha) planned in the centre of the EUC would be the best place to locate a community building.

- Parking and more major sports amenities created during park development to share benefits with the building.
- Due to expense few buildings can be funded in any given year and there is a priority list.
- Such a building is going to make the list for the next city-wide Development Charges update review which is now on-going (good news)
- On the list for consideration in the 2025 to 2029 period.



Dog Park?

# Elections and Adjournment

Nominations for President, Vice-President,  
Treasurer and Secretary

Volunteers welcome to participate on our board

We meet once every two months

Remember to check our Facebook and our Website for up-to-date information

3-1-1

<http://ottawa.ca/en/serviceottawa>

Snow removal

Parking

By-law violations

Garbage

Traffic (and call OPS 613-236-1222 for traffic complaints, speeding)

Potholes

Sidewalk and path maintenance

.....

[illegible]

